

Guandii and 4k club, Shanghai

官邸，上海





### 甘泰來 Tai Lai Kan

齊物設計事業有限公司 總監  
 交通大學建築研究所 兼任講師  
 實踐大學建築研究所 兼任講師  
 哥倫比亞大學建築碩士（獲榮譽獎項畢業）  
 康乃爾大學建築與都市設計研究所研究  
 東海大學建築學士

General director, archinexus co., ltd.  
 Lecturer, Graduate Institute of Architecture, National Chiao Tung University  
 M.A., Columbia University (with honors)  
 Graduate study, Cornell University  
 B.A., Tunghai University

設計者 | 齊物設計 甘泰來

參與者 | 陳思潔 林詠淳 張耀文

攝影者 | 盧震宇

空間性質 | 餐飲空間

坐落位置 | 上海市復興公園

主要材料 | 米色洞石、挪威森林石材、鐵刀木石材、實木染色、馬賽克、銅鏡、鐵件、皮革、織品

面積 | 230坪

設計時間 | 2009年8月至10月

竣工時間 | 2009年 12月

Designer | archinexus / Tai Lai Kan

Participants | S.C. Chen / Y.C. Lin / Y.W. Chen

Photographer | Z. Y. Lu

Category | restaurant

Location | Shanghai

Material | cavity stone, Norwegian stone, hardwood stone, dyed wood, mosaic, copper mirror, metal, leather, fabric

Size | 760m<sup>2</sup>

Design period | August - October 2009

Completion | December 2009

複合式餐飲空間「官邸」，位於上海「復興公園」內，公園環境的寧靜綠意與時尚夜空間時髦繽紛的差異性，讓彼此關係產生了衝突趣味，這份特殊性也勾動了全案的設計靈感。設計師期望，「官邸」猶如一座光點，外觀安靜卻極具存在感的佇立於公園之中，而內部則能彰顯所在城市的文化活力、多元面貌等特色，由外而內建構出別致的消費體驗。

設計師以別有洞天的探索經驗，呼應「官邸」採取會員制的經營特色。隱身於公園內的寓所，外觀由一座LED屏幕大門作為起始，密緻的光點能感應門前動態，連動顯影效果，環境綠意與科技裝置的強烈對比，也揭示了空間經驗的獨特性。考量賓客隱私需求，全案共規劃兩座入口，分別將動線接駁至一樓挑空區與夾層、包廂區，包廂區並規劃引導通道保護賓客的隱私需求。

一樓挑空區為開放式餐飲空間，規劃吧台、卡座區、舞台區，舞台旁安置了一座橢圓形的Jacuzzi水池，豐富動態表演效果。設計師在一樓邊側規劃半開放式包廂，拉上絲絨簾幔即可彈性區隔座區與視景，調節包廂內部的隱密性。全案利用基地既有的結構柱作為展呈視覺華麗的媒介，為空間序列的柱體圍覆上鏤空雕刻板，內置LED燈，縱向燈柱不僅擴張出深長的景深效果，也兼具了裝飾、氛圍營塑等功能。有趣的是，擅長數位運算的設計團隊，為本案積極連結了文字與空間的關係，以「官」字作為原形，衍生出簡潔的幾何圖形，作為鏤空板的造型圖騰。鏤空板包覆於燈柱、矮牆上，洞孔隨著內部裝置的LED燈變換彩光，與空間大量的絲絨材質產生了互動性，隨著織品本身受光所不斷回應的多彩光澤，為空間渲染上漸層色彩；也藉由光影流動與嬉戲文字的鋪陳手法，再現東方文字之美。

設計師在本案企圖探索工業設計的多元用途，透過別出心裁的設計融合了家具、器皿、燈飾，體現出空間服務的細緻度。沙發椅背下段規劃10公分深的凹槽提供女士放置皮包，保留下寬敞的椅面，讓坐姿更為優雅舒適。茶几採取一體多用的複合規劃，納入了LED屏幕、冰筒、照明、收納等多項功能，簡練桌面陳設。同時，利用區隔座席的矮牆巧妙隱藏收納機能，讓工作人員能更靈活且即時的提供服務。

夾層區採取樓廊式規劃，樓層區別所產生的距離感，讓視野能盡收一樓舞台的表演動態，亦可隔絕外界干擾。大包廂是更為隱密的私屬空間，規劃沙發區、影音設備、撞球桌台。包廂內褪去炫爛多彩的裝飾元素，以低斂、溫暖的氛圍融合新舊意象，利用實木拼花地坪、大量的絲絨元素回應上海城的華麗風情。當窗幔輕啟，視野可望至安靜的公園景象，青翠的窗景背幕再度回應了基地環境的特質。在內外疆界之間，大窗宛如櫺窗般重疊了室內外的景象，在蔥鬱葉群裡藏入了一個真實又華麗的世界，勾動人們隱約窺視的好奇想像，也為公園留下了一幅誘人仰望的亮點。採訪 | 劉蕙蘋

1. 夾層區延伸燈柱造型，統合空間裡的裝飾元素。

1. Mezzanine level and its lighting fixtures

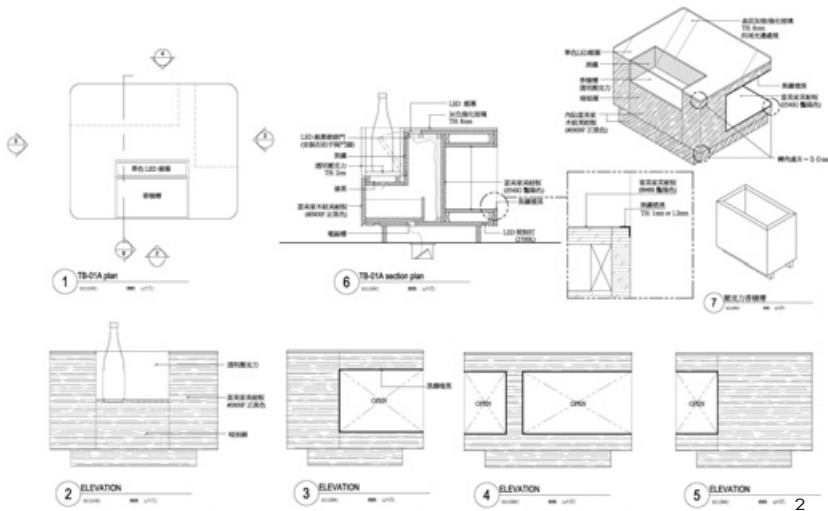

2. 茶几設計細部圖。3. 半開放式大包廂。4. 茶几採取一體多用的複合規劃，納入了LED屏幕、冰筒、照明、收納等多項功能，簡練桌面陳設。5. 夾層區樓層區別所產生的距離感，讓視野能盡收一樓舞台的表演動態。6. 設計師在一樓邊側規劃半開放式包廂，拉上絲絨簾幔即可彈性區隔座區與視景，調節包廂內部的隱密性。

2. Tea stool design drawing 3. Semi-open box room 4. Box space at the mezzanine level can open up the wider view to the lower dancing pool 5. Tea stool provides multiple function like ice-bucket, lighting fixture etc. 6. Silk screen can open up the box room or veil the room



Guandii and 4k club is located inside Fu-Sin Park, Shanghai. The club and its trendy fashion is in direct contrast to the atmosphere of the tranquil park. Ken saw the contrast yet wondered how it was possible that the contrast will turn out to be of interest. It is possible that the building is like a flashing beacon radiating its energy to the calm surroundings.

The club only accepts private members to come in and hide behind a LED screen, which turns out to be a signifier of the club. Sensors can detect movement from any corner and the activated lighting displays changes of various designated qualities. To protect a member's privacy, there are two gateways; one leads to the first floor and the other to a private lounge on a mezzanine level. The private lounge even has an escape route when necessary.

The first floor is a large open restaurant, housing a bar, a cartridge sitting zone, and a dancing pool. An oval Jacuzzi water pool is laid out

besides the dancing pool and offers a dynamic view for this space. There are several semi- enclosed rooms and when the silk screens are lowered the rooms can be completely secluded. Existing columns are all clad with embroidered metal panels with LED lighting fixtures hidden within; illuminated columns increase spatial the depth and are a good mechanism to easily ignite a guest's passion. The most interesting design comes from the pattern design shown on the metal boards; every visible single pattern is derived from the Chinese character "Guan", that is the first word of the Club's name. LED lighting is everywhere, and its fascinating glare shows reflective strokes on the surface of the silky fabric as the light moves around and gives the most impressive view to attendants.





4



5



6



7. 利用基地既有的結構柱作為燈柱，擴張出深長的景深效果，也兼具了裝飾、氛圍營塑等功能。8. 以「官」字作為原形，衍生出簡潔的幾何圖形，作為全案的裝飾語彙。9. 鏤刻板設計發想概念圖。

7. Structural columns and their lighting effect increases spatial depth 8. "Guan" -the Chinese character is deconstructed into many iconic patterns 9. Metal board conceptual drawing



7



8

Designers also explore every possible development of the night club furniture, utensil, and lighting fixture designs. A sofa chair leaving a small gouge 10 centimeters deep not only offers better lumber support but also gives a small space for a lady's purse to be stored. The tea-stool is for multiple uses; it can be used as an ice-bucket and as a lighting fixture stand. Carefully detailed walls are used for storage compartments that service attendants can easily access.

The mezzanine level is laid out like a gallery with steps; the level gap opens everybody's view to the dancing pool which can veil any curious scrutiny from a lower positions. A big box room is an even more secluded space that completely cuts out everything from the outside except a window that can cast views towards the beautiful park. There are sofa areas, an entertainment quarter, and billiard pool. The interior is furnished with wood floors and silky drapery. The window accepts views of both the interior and exterior and opens up a dream window to enjoy the exclusive beauty and domination. Translated by Ray S.C.Chu & David Mark Riz



10



11

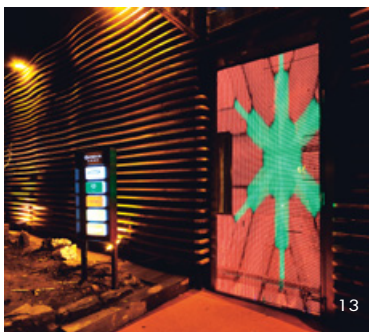

13

10. 夾層空間的包廂利用的階梯規劃，劃分各個座區的範圍。11. 大包廂規劃沙發區、影音設備、撞球桌台，滿足多元娛樂的需求。12. 大包廂利用實木拼花地坪、大量的絲絨材質回應上海城的華麗風情。藉由青翠的窗景背景，回應了基地身處於公園內的特色。13. LED 屏幕大門密緻的光點能感應門前動態，連動顯影效果。14. 一樓平面圖。15. 夾層平面圖。

10. Stepped sitting is convenient for everybody to look down 11. Main box room and its grand window open up a view to Fun-Sin Park 12. Sofa zone, entertainment quarter and billiard pool are arranged inside grand box room 13. LED screen is sensor activated 14. The first floor plan 15. The mezzanine level plan



12

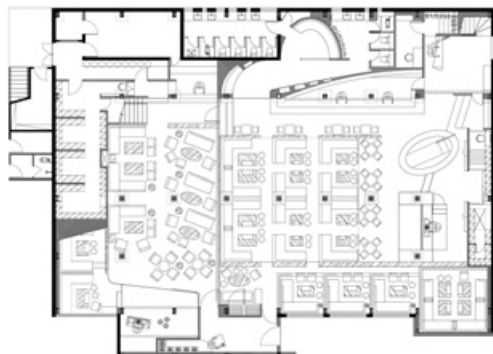

14



15