

## Arthouse Café, HENCHAO

# Arthouse Café, 杭州

設計者 JOEY HO DESIGN / 何宗憲 Joey Ho  
參與者 Yiki Leung, Momoko Lai  
攝影者 Wu Yong Chang  
空間性質 餐廳  
坐落位置 中國杭州  
主要材料 木材、大理石、玻璃  
面積 3,000平方英尺  
完工時間 2010年11月

Designer JOEY HO DESIGN / Joey Ho  
Participants Yiki Leung, Momoko Lai  
Photographer Wu, Yong Chang  
Category restaurant  
Location HENCHAO, China  
Materials timber, marble, glass  
Size 3,000 square feet  
Completion November 2010

Arthouse Café開設於杭州企業園區的藝術館內，坐落於建築物的三樓。該館主要功能為展示企業收藏、動靜態活動使用，提供企業人員或往來客戶作為洽談交誼的場地。設計師以空間思維策劃，運用「移動的三角形」概念探討人與物的動態關係，讓咖啡廳裡人、物不斷連動的視景變化，帶引賓客跳脫習以為常的空間經驗。（本案獲得2011 Gold Key Awards Lounge/Bar項目決選，2011 JCD Design Award 飯島直樹賞，2011亞太設計大獎餐飲空間銀獎。）採訪 劉蕙蘋

Arthouse Café is an attached service facility inside the art gallery of HENCHAO Enterprise Park. Its main functions are to offer showroom space for businesses and the necessary social facilities for interaction between buyers and suppliers. The design concept was derived from research into the relationship between object and body, and out came the idea of the movable triangle realized in a coffee shop. (This project won the 2011 Gold Key Awards Finalists Lounge/Bar category, 2011 JCD Design Award Naoki Iijima Award, 2011 Asia Pacific Interior Design Awards (APIDA) Silver, Food space category.)

1. 三角量體以不同角度、大小、形態編設於空間裡，形成多角度和多層次的視覺效果。2. 運用「移動的三角形」概念探討人與物的動態關係。

1. Triangular skeleton frameworks in the café build dynamic visual axes 2. "Movable triangle" is the concept of the design



1



2





### 設計概念

在日常裡，物體移動和靜態空間常以相反的姿態出現，流動的人體與靜態場地形成對比，似乎已成定律。全案設計從動態概念出發，企圖為靜止的空間加入動態元素，讓移動的人體在動態的環境裡穿梭，模糊空間與人體流動的定界，在人與物的行動對話裡提供獨特的空間經驗。

全案設計從動靜轉換的科學角度出發，配以幾何學的靈感來源，發展出「移動的三角形」概念。整體造型語彙自基地的三角地形開始想像，設計師運用幾何三角呼應地形環境，藉由三角形的指向性營造空間動態，創造有別以往的視覺體驗。空間畫面宛若定格了三角形舞動遊戲的瞬間，這些立體的三角量體以不同角度、大小、形態編設於全案，猶如動畫中的三維關係具像並存於現實裡，經由巧妙的透視與疊景經營，為空間構築了多角度與多層次的視覺效果，當賓客身處在不同位置，都能感受三角形圍繞下所衍生的線、面結構，步伐穿梭於空間時亦能領受豐富的視景遞變。

設計師更以線條突顯出三角形的立體感與方向性，大量採用胡桃木集層材，藉其筆直紋理意喻自然元素的超現實化，為空間帶來豐富的細節，局部地坪亦鋪設實木集層材，創造豐富的地景層次。場域安排上，刻意留下寬闊走道，讓各座位編排於三角量體左右，巧妙地以結構造型作為屏障，確保各座區交談內容的隱私性。

空間特意使用靜白基調深刻超現實的氛圍，透過亮潔的人造石地板烘托三角量體的飄浮特色，強調豐沛的自然採光與冷色調的燈光設計，讓賓客無論日夜身處其中，都能產生一種走入於雕塑藝術的趣味。同時，為了確保視線的通透感，特意將燈槽隱藏在三角量體內，維繫幾何造型的簡潔氣質。全案就在動態表情中，引導空間與人互望風景，在不斷建構與解構的視景下，換上新新角度細味環境。

3. 空間以靜白基調深刻超現實氛圍，透過亮潔的人造石地板烘托三角量體的飄浮感。4. 巧妙的透視與疊景經營，讓賓客身處在不同位置都能感受三角形圍繞下所衍生的線、面變化。  
3. White color used inside the café gives a sense of surrealism—a shining marble floor seems to give the triangle framework an invisible power to levitate up in sky 4. Layering perspective systems directs a rich and unsettled visual wandering



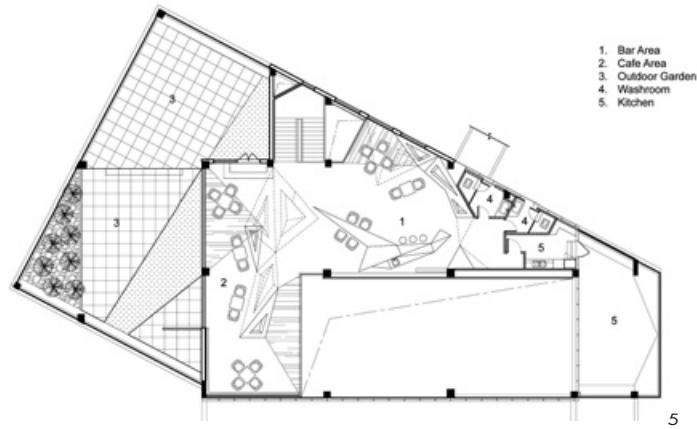

5. 平面圖。6. 強調採光優勢以及冷色調燈光設計，讓咖啡廳日、夜都擁有不同氛圍。7. 選用George Nelson和Konstantin Grcic的設計椅，以重現結構線條的椅座搭配流線造型的吧台，呼應空間整體的動感意象。8. 運用集層材的筆直線條突顯三角形的立體感與方向性，並建立出豐富的地景層次。  
 5. Plan after conversion 6. Lighting design assures different moods in daytime and night 7. George Nelson& Konstantin Grcic' designed chairs match well with the bar table curvature 8. Laminated wood boards and its constructive details for the triangular systems

**Design Concept**

In daily life, object and body possess a relative position when a static relationship is formed because objects and bodies always stay in the positions they were designated to. This design changes the relationship and builds constantly changing positions of both the objects and bodies. Moving bodies offer a new experience of space and blur the border between them.

The plan has a unique feature that shows several regulation lines forming triangle shapes in the scheme. At first, the existing floor plan shows an obvious triangular shape, the primary geometry. Then the primary shape is divided into several triangles and each has its own distinct axis directing one's sight to wander about. Human experience in the space is dynamic. Not only does the rich perceptive layering offer spatial interest, human bodies are the objects that invite curiosity.

Material provides another asset to augment the speed and energy in this space. Walnut laminated wood boards are extensively used because the vertical patterns of laminated boards are useful in increasing the perspective guiding system. Even some parts of floor are paved with laminated wood boards. Several over-sized pathways appear and all surround the triangular sitting zones fenced in by screens that protect the necessary privacy of the customers.

The main service space has a surreal mood like an over-exposed film. Shining artificial stone flooring and its reflective surface seem to levitate up the triangle volumes by some invisible power. Ample natural light and cold tone artificial lighting gives the space a particular ambience like an art gallery. There aren't any extruding lighting fixtures; they are all hidden inside in gloves and are attached to the triangular system. The landscape inside the room has no fixation rather like changeable scenes of montage images. Each fragmented scene integrates into another to form a transient yet dynamic spatial interest.







### 建材分析

選用George Nelson和Konstantin Grcic的設計椅，以重視結構線條的椅座配搭流線造型的吧台，呼應空間整體的動感意象。以集層材線條突顯三角形的立體感與方向性，為空間帶來豐富的細節，其筆直紋路將自然元素超現實化，藉此呼應「移動的三角形」概念。

### 溝通重點

空間能隨著日夜時段變化氛圍，滿足白天供應咖啡、夜晚供應軟性飲料等需求。

把立體的三角形以不同角度、大小、形態編設於空間裡，形成多角度和多層次的視覺效果，探索介面形成和轉換過渡的可能性。設計團隊以模型為業主及施工單位詳細說明設計概念與整體結構，讓乍看前衛複雜的造型，解開其蘊含的幾何元素與層疊手法，達成彼此的溝通與理解目的。

### Material Analysis

George Nelson & Konstantin Grcic's designed chair was selected to be the main seating piece in the bar; its highly liquid shape matches quite well with the organic shape of bar table.

Laminated wood creates the "spatial triangles" in the space. The rich horizontal pattern on the surface enriches a mystic and surreal sense of the space.

### Communication Notes

Arthouse Café offers coffee in daytime with soft alcohol beverages at night. There are several wood frameworks posing many triangular shapes in the space. When these frameworks meet, they create ambiguous visual axes. This skewed and layering pattern gives the space a sophisticated picture like a riddle needed to be solved.

9. 巧妙地以三角造型作為屏障，確保各座區交談內容的隱私性。10. 設計概念。11. 藉由三角的指向性營造空間動態，創造獨特的視覺體驗。12. 將燈槽隱藏在三角量體內，維繫幾何造型的簡潔氣質。

9. Partitions that protect customer's privacy 10. Design Concept drawing 11. Triangle shape gives district visual axes the power to guide bodies to move 12. Lighting is hidden inside the triangle framework

